

TECHNICAL DATA SHEET

CARTRIDGE

FILTER HOUSING

CFHA MODELS

General information

CFHA MODEL	
PURPOSE	<ul style="list-style-type: none"> The Cartridge Filter Housings – CFHA models* with inner Halar coating offer reliable high-quality filtration for nanotech manufacturing and fulfill the specific needs of Ultrapure water applications such as Semiconductor and UPW polishing. All wetted surfaces of the Cartridge Filter Housings – CFHA models are fluoropolymer lined to ensure Ultrapure water never comes in contact with exposed metal. Ovivo Cartridge Filter Housings – CFHA models are available in different diameters and can support 5 to 28 filter cartridges. The feed water goes in the housing and evenly pass through the filter cartridges (outside-in filtration). Particles are captured on the filter cartridges surface and the filtrate is collected at the housing outlet.
INSTALLATION	<ul style="list-style-type: none"> The Cartridge Filter Housings – CFHA models are often skid mounted and shall be installed either indoor or outdoor on level ground. The installation and operation of the Cartridge Filter Housings – CFHA models must follow specific requirements. Ovivo's filter housings are compatible with almost every filter media (cartridges) available on the market. See operation manual or contact Ovivo for further information.
OPERATION	<ul style="list-style-type: none"> There is no specific maintenance on the Cartridge Filter Housings – CFHA models. The vessel shall be periodically submitted to structural examination. A modification of the pressure test of the vessel is not permitted. Filter cartridges must be cleaned according to supplier information and/or following Ovivo recommendations.

*CFHA models refer to CFEHA (Cartridge Filter Housing according to European Standard with inside Halar coating) and CFAHA (Cartridge Filter Housing according to ASME with inside Halar coating).



Materials

CFHA MODELS		
HOUSING	Outside Inside	Stainless Steel 316L (1.4404) Halar® ECTFE
BAFFLE PLATE		Stainless Steel 316L (1.4404) Halar® ECTFE
CARTRIDGE HOLDING PLATE		PVDF
SUPPORT RODS, NUTS		PVDF
CARTRIDGE HOLD DOWN PLATE		PVDF

Characteristics

CFHA MODELS		5-30	5-40	8-30	8-40	12-30	12-40	18-30	18-40	22-30	22-40	28-30	28-40
HOUSING DIAMETER	mm	220	270	325	410	460	510						
	inch	8.7	10.6	12.8	16.1	18.1	20.1						
CONNECTION*	mm	80	80	100	100	150	150	150	150	150	150	150	150
	inch	3	3	4	4	6	6	6	6	6	6	6	6
TOTAL HEIGHT L1	mm	1'537	1'787	1'548	1'798	1'869	2'119	1'928	2'178	2'059	2'309	2'086	2'336
	inch	60.5	70.4	60.9	70.8	73.6	83.4	75.9	85.7	81.1	90.9	82.1	92.0
FLANGE POSITION L2	mm	918	953	944	1'051	1'231	1'256						
	inch	36.1	37.5	37.2	41.4	48.5	49.4						
FLANGE POSITION L3	mm	320	320	350	350	440	440						
	inch	12.6	12.6	13.8	13.8	17.3	17.3						

*The size of the connection is a variable depending on the flow rate.

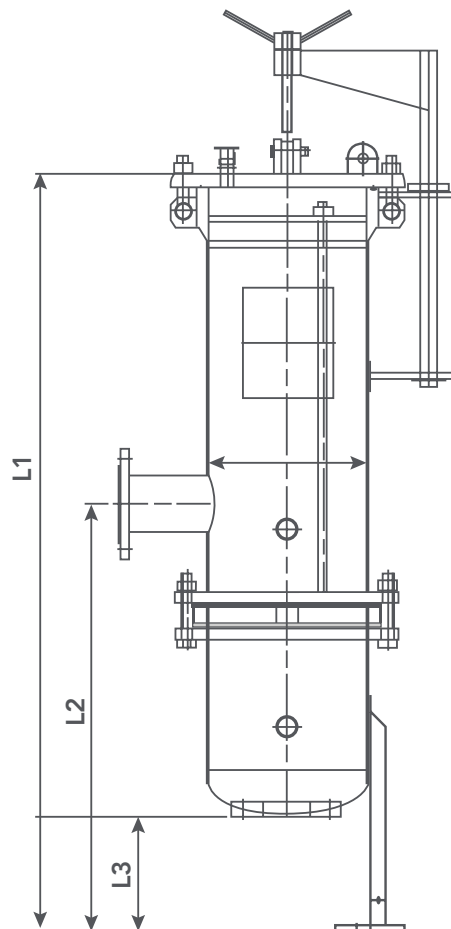

Operating parameters

CFHA MODELS		5-30	5-40	8-30	8-40	12-30	12-40	18-30	18-40	22-30	22-40	28-30	28-40
MEDIUM		Water											
DESIGN PRESSURE	bar psi	-1 ... 10 -14.5 ... 145											
MAX. ALLOWABLE WORKING PRESSURE	bar psi	-1 ... 10 -14.5 ... 145											
DESIGN TEMPERATURE	°C °F	120 248											
ALLOWABLE WORKING TEMPERATURE	°C °F	0 ... 100 32 ... 212											
NUMBER OF CARTRIDGES		5		8		12		18		22		28	
NUMBER OF 10" CARTRIDGE ELEMENTS		15	20	24	32	36	48	54	72	66	88	84	112
LENGTH OF CARTRIDGES*	mm	750	1'000	750	1'000	750	1'000	750	1'000	750	1'000	750	1'000
	inch	30	40	30	40	30	40	30	40	30	40	30	40
MAX. FLOW	m ³ /h	23	30	36	48	54	72	81	108	99	132	126	168
	gpm	101	132	159	211	238	317	357	476	436	581	555	740

*Cartridge Filter Housings for smaller cartridges, such as 10" or 20" are also available on special request.

Operating principle

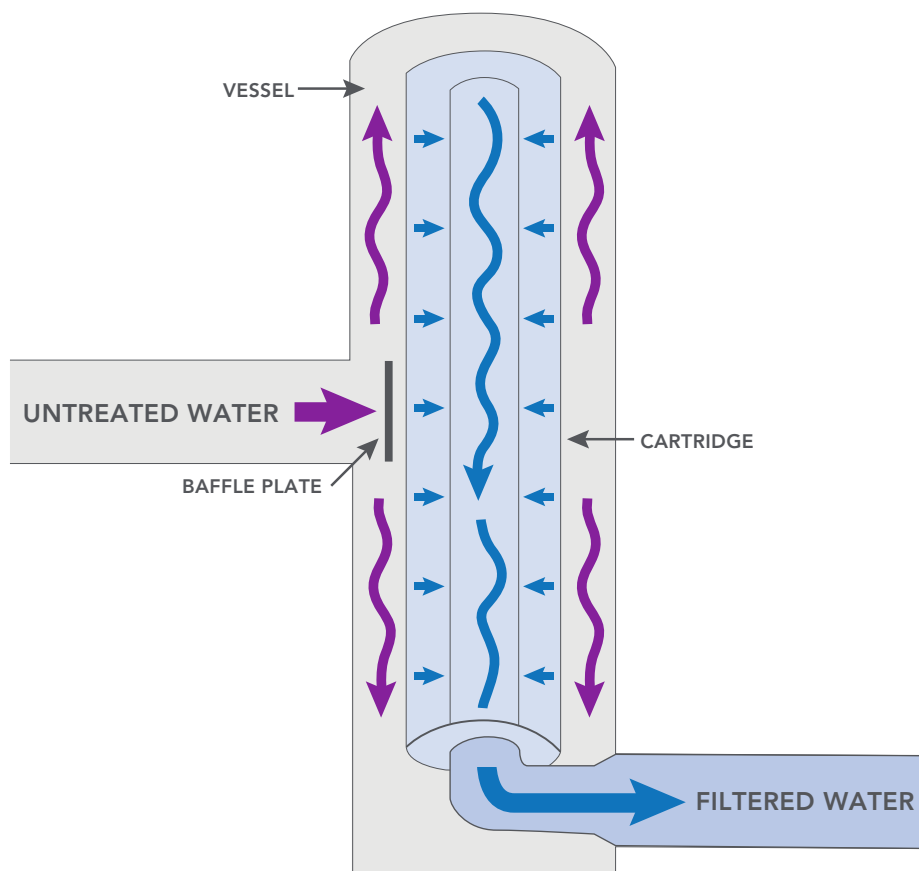

Quality

PRESSURE EQUIPMENT DIRECTIVE (PED)

- Designed, developed and manufactured in accordance with the Pressure Equipment Directive - 2014/68/EU, Article 4, paragraph 3 (Sound Engineering Practice).

ASME VIII. DIV.1 (AS ALTERNATIVE TO PED)

- The Cartridge Filter Housings – CFHA models are designed and manufactured in accordance with ASME VIII. DIV. 1.
- An ASME U-stamp on the pressure vessel is available in option.

OTHERS (ON REQUEST)

- The Cartridge Filter Housings – CFHA models are designed and manufactured to be compliant with Semiconductors and Ultrapure water requirements.

Other information

DISPOSAL	<ul style="list-style-type: none">• Disposal must be in accordance with the appropriate local regulations.• See additional information in the operation manual.
SAFETY ADVICE	<ul style="list-style-type: none">• Pressure hazards: The Cartridge Filter Housings – CFHA models are operated under pressure. Risk of liquid jets during maintenance work.• Unauthorized modification of the Cartridge Filter Housings – CFHA models will void warranty. We recommend using only original spare parts for system maintenance.
MANUFACTURER	RAMIVO Manufacturing Hungary Kft. Szabadság utca. 91 7090 Tamási Hungary
GLOBAL KNOWLEDGE CENTRE	Ovivo Switzerland AG Benkenstrasse 262 4108 Witterswil Switzerland

